

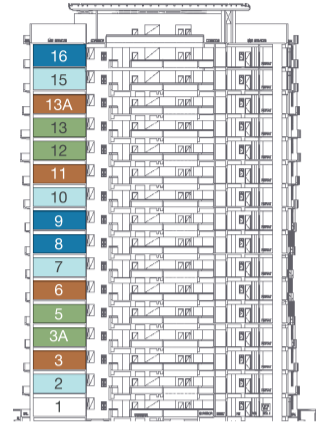

# D 1

## TYPE A FLOOR AREA UNIT= 1,646ft<sup>2</sup>



LEVEL 2, 7, 10, 15  
BALCONY = 351 ft<sup>2</sup>  
TOTAL FLOOR AREA = 1,997 ft<sup>2</sup>

LEVEL 3, 6, 11, 13A  
BALCONY = 402 ft<sup>2</sup>  
TOTAL FLOOR AREA = 2,047 ft<sup>2</sup>

LEVEL 3A, 5, 12, 13  
BALCONY = 447 ft<sup>2</sup>  
TOTAL FLOOR AREA = 2,093 ft<sup>2</sup>

LEVEL 8, 9, 16  
BALCONY = 301 ft<sup>2</sup>  
TOTAL FLOOR AREA = 1,947 ft<sup>2</sup>



Note :   
 • Subject to variations, modifications and substitutions as may be required by the Authorities or recommended by Architect or Engineer.   
 • Subject to the final survey by the licensed land surveyor.



BLOCK

D 1

TYPE B

FLOOR AREA

UNIT= 1,678ft<sup>2</sup>

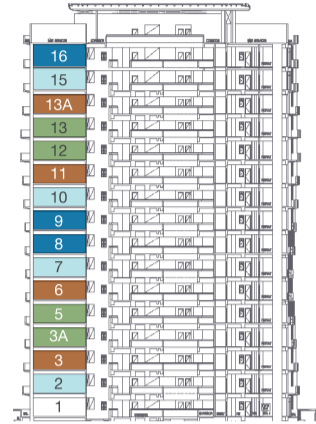

LEVEL 2, 7, 10, 15  
BALCONY = 364 ft<sup>2</sup>  
TOTAL FLOOR AREA = 2,042 ft<sup>2</sup>

LEVEL 3, 6, 11, 13A  
BALCONY = 322 ft<sup>2</sup>  
TOTAL FLOOR AREA = 2,000 ft<sup>2</sup>

LEVEL 3A, 5, 12, 13  
BALCONY = 276 ft<sup>2</sup>  
TOTAL FLOOR AREA = 1,954 ft<sup>2</sup>

LEVEL 8, 9, 16  
BALCONY = 402 ft<sup>2</sup>  
TOTAL FLOOR AREA = 2,080 ft<sup>2</sup>

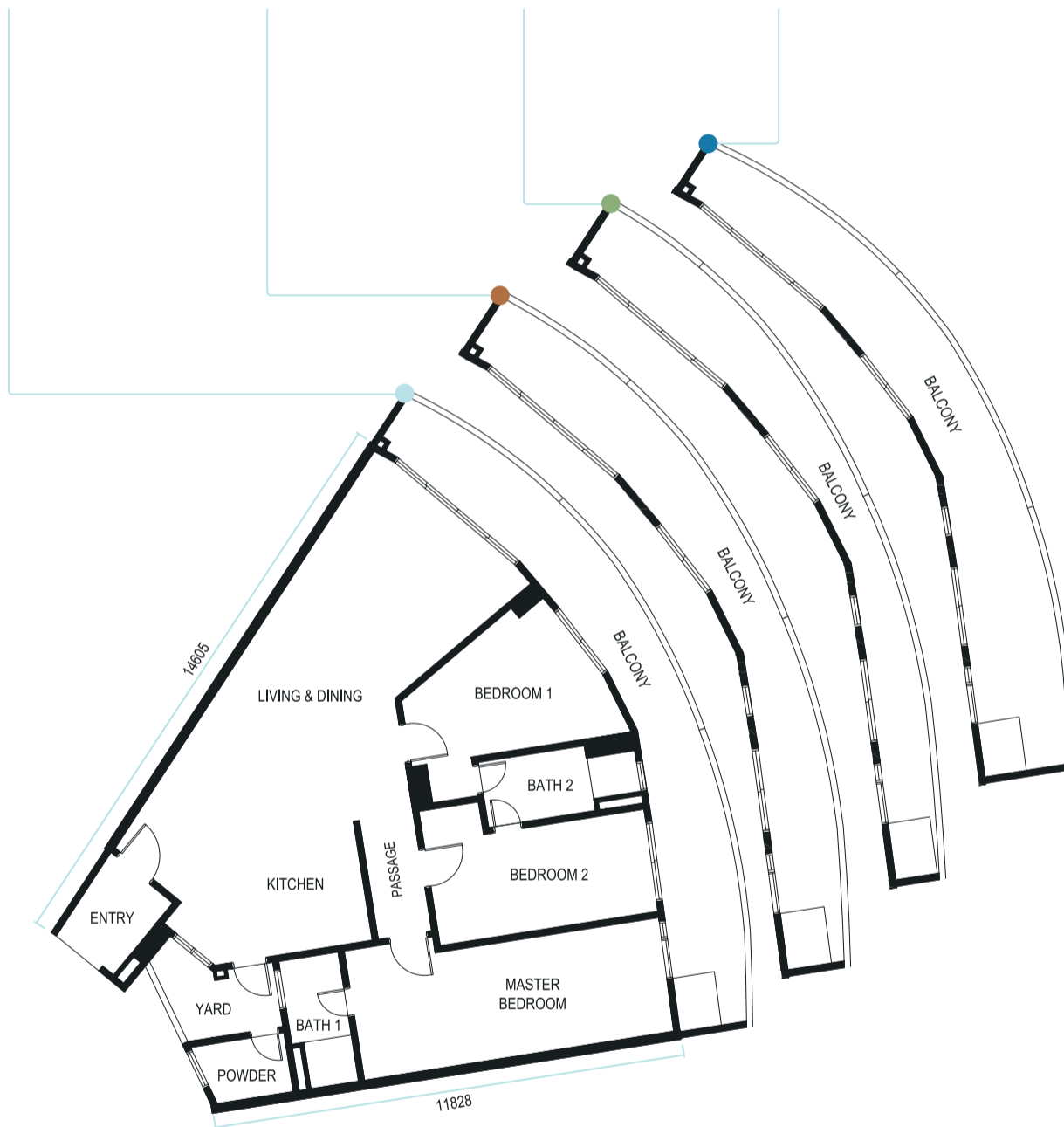

Note :  
• Subject to variations, modifications and substitutions as may be required by the Authorities or recommended by Architect or Engineer.  
• Subject to the final survey by the licensed land surveyor.



# D 1

## TYPE C FLOOR AREA UNIT= 1,647ft<sup>2</sup>

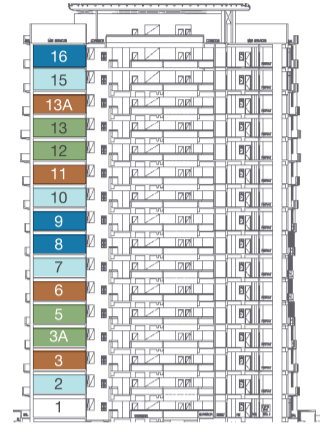

LEVEL 2, 7, 10, 15  
BALCONY = 271 ft<sup>2</sup>  
TOTAL FLOOR AREA = 1,918 ft<sup>2</sup>

LEVEL 3, 6, 11, 13A  
BALCONY = 250 ft<sup>2</sup>  
TOTAL FLOOR AREA = 1,897 ft<sup>2</sup>

LEVEL 3A, 5, 12, 13  
BALCONY = 233 ft<sup>2</sup>  
TOTAL FLOOR AREA = 1,880 ft<sup>2</sup>

LEVEL 8, 9, 16  
BALCONY = 296 ft<sup>2</sup>  
TOTAL FLOOR AREA = 1,943 ft<sup>2</sup>



Note :  
• Subject to variations, modifications and substitutions as may be required by the Authorities or recommended by Architect or Engineer.  
• Subject to the final survey by the licensed land surveyor.



# D 1

## TYPE D FLOOR AREA UNIT= 1,809ft<sup>2</sup>

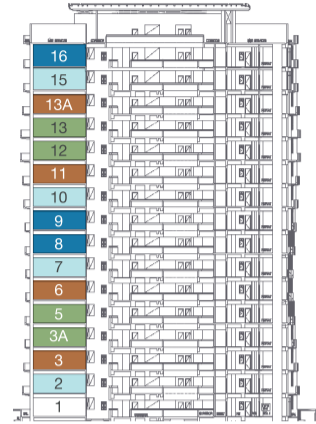

LEVEL 2, 7, 10, 15  
BALCONY = 331 ft<sup>2</sup>  
TOTAL FLOOR AREA = 2,140 ft<sup>2</sup>

LEVEL 3, 6, 11, 13A  
BALCONY = 358 ft<sup>2</sup>  
TOTAL FLOOR AREA = 2,167 ft<sup>2</sup>

LEVEL 3A, 5, 12, 13  
BALCONY = 383 ft<sup>2</sup>  
TOTAL FLOOR AREA = 2,192 ft<sup>2</sup>

LEVEL 8, 9, 16  
BALCONY = 304 ft<sup>2</sup>  
TOTAL FLOOR AREA = 2,113 ft<sup>2</sup>



Note :  
• Subject to variations, modifications and substitutions as may be required by the Authorities or recommended by Architect or Engineer.  
• Subject to the final survey by the licensed land surveyor.



# BLOCK D 1

TYPE E  
FLOOR AREA  
UNIT= 1,780ft<sup>2</sup>

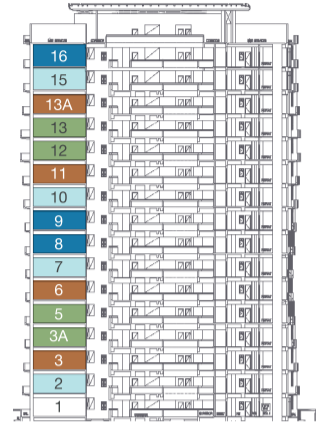

LEVEL 2, 7, 10, 15  
BALCONY = 295 ft<sup>2</sup>  
TOTAL FLOOR AREA = 2,075ft<sup>2</sup>

LEVEL 3, 6, 11, 13A  
BALCONY = 318 ft<sup>2</sup>  
TOTAL FLOOR AREA = 2,098 ft<sup>2</sup>

LEVEL 3A, 5, 12, 13  
BALCONY = 338 ft<sup>2</sup>  
TOTAL FLOOR AREA = 2,118 ft<sup>2</sup>

LEVEL 8, 9, 16  
BALCONY = 269 ft<sup>2</sup>  
TOTAL FLOOR AREA = 2,049 ft<sup>2</sup>



Note :  
• Subject to variations, modifications and substitutions as may be required by the Authorities or recommended by Architect or Engineer.  
• Subject to the final survey by the licensed land surveyor.



# BLOCK D 1

TYPE F  
FLOOR AREA  
UNIT= 1,780ft<sup>2</sup>

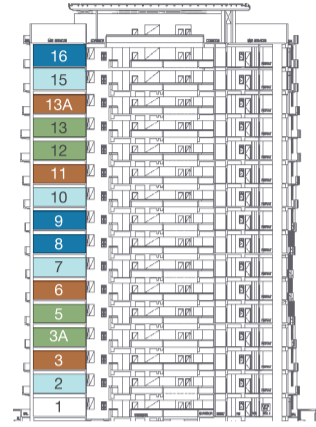

LEVEL 8, 9, 16  
BALCONY = 491 ft<sup>2</sup>  
TOTAL FLOOR AREA = 2,271 ft<sup>2</sup>

LEVEL 3A, 5, 12, 13  
BALCONY = 244 ft<sup>2</sup>  
TOTAL FLOOR AREA = 2,024 ft<sup>2</sup>

LEVEL 3, 6, 11, 13A  
BALCONY = 328 ft<sup>2</sup>  
TOTAL FLOOR AREA = 2,108 ft<sup>2</sup>

LEVEL 2, 7, 10, 15  
BALCONY = 411 ft<sup>2</sup>  
TOTAL FLOOR AREA = 2,191 ft<sup>2</sup>



Note :  
• Subject to variations, modifications and substitutions as may be required by the Authorities or recommended by Architect or Engineer.  
• Subject to the final survey by the licensed land surveyor.



# D 1

## TYPE G FLOOR AREA UNIT= 1,195ft<sup>2</sup>

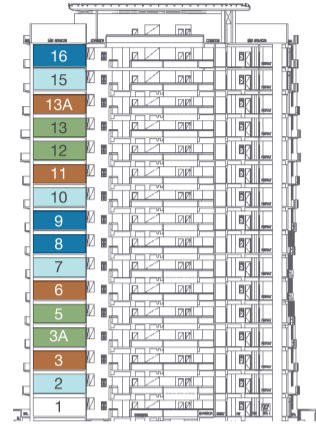

LEVEL 8, 9, 16  
BALCONY = 180 ft<sup>2</sup>  
TOTAL FLOOR AREA = 1,375 ft<sup>2</sup>

LEVEL 3A, 5, 12, 13  
BALCONY = 119 ft<sup>2</sup>  
TOTAL FLOOR AREA = 1,314 ft<sup>2</sup>

LEVEL 3, 6, 11, 13A  
BALCONY = 136 ft<sup>2</sup>  
TOTAL FLOOR AREA = 1,331 ft<sup>2</sup>

LEVEL 2, 7, 10, 15  
BALCONY = 156 ft<sup>2</sup>  
TOTAL FLOOR AREA = 1,351 ft<sup>2</sup>



Note :  
• Subject to variations, modifications and substitutions as may be required by the Authorities or recommended by Architect or Engineer.  
• Subject to the final survey by the licensed land surveyor.



BLOCK

D 1

TYPE H

FLOOR AREA

UNIT= 1,701ft<sup>2</sup>

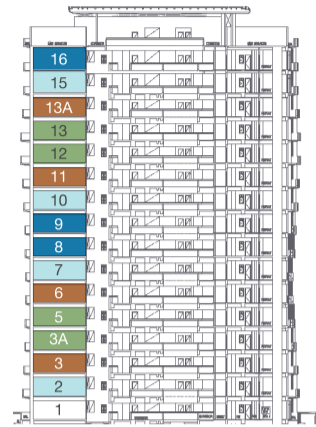

LEVEL 8, 9, 16  
BALCONY = 221 ft<sup>2</sup>  
TOTAL FLOOR AREA = 1,922 ft<sup>2</sup>

LEVEL 3A, 5, 12, 13  
BALCONY = 369 ft<sup>2</sup>  
TOTAL FLOOR AREA = 2,070 ft<sup>2</sup>

LEVEL 3, 6, 11, 13A  
BALCONY = 319 ft<sup>2</sup>  
TOTAL FLOOR AREA = 2,020 ft<sup>2</sup>

LEVEL 2, 7, 10, 15  
BALCONY = 269 ft<sup>2</sup>  
TOTAL FLOOR AREA = 1,970 ft<sup>2</sup>

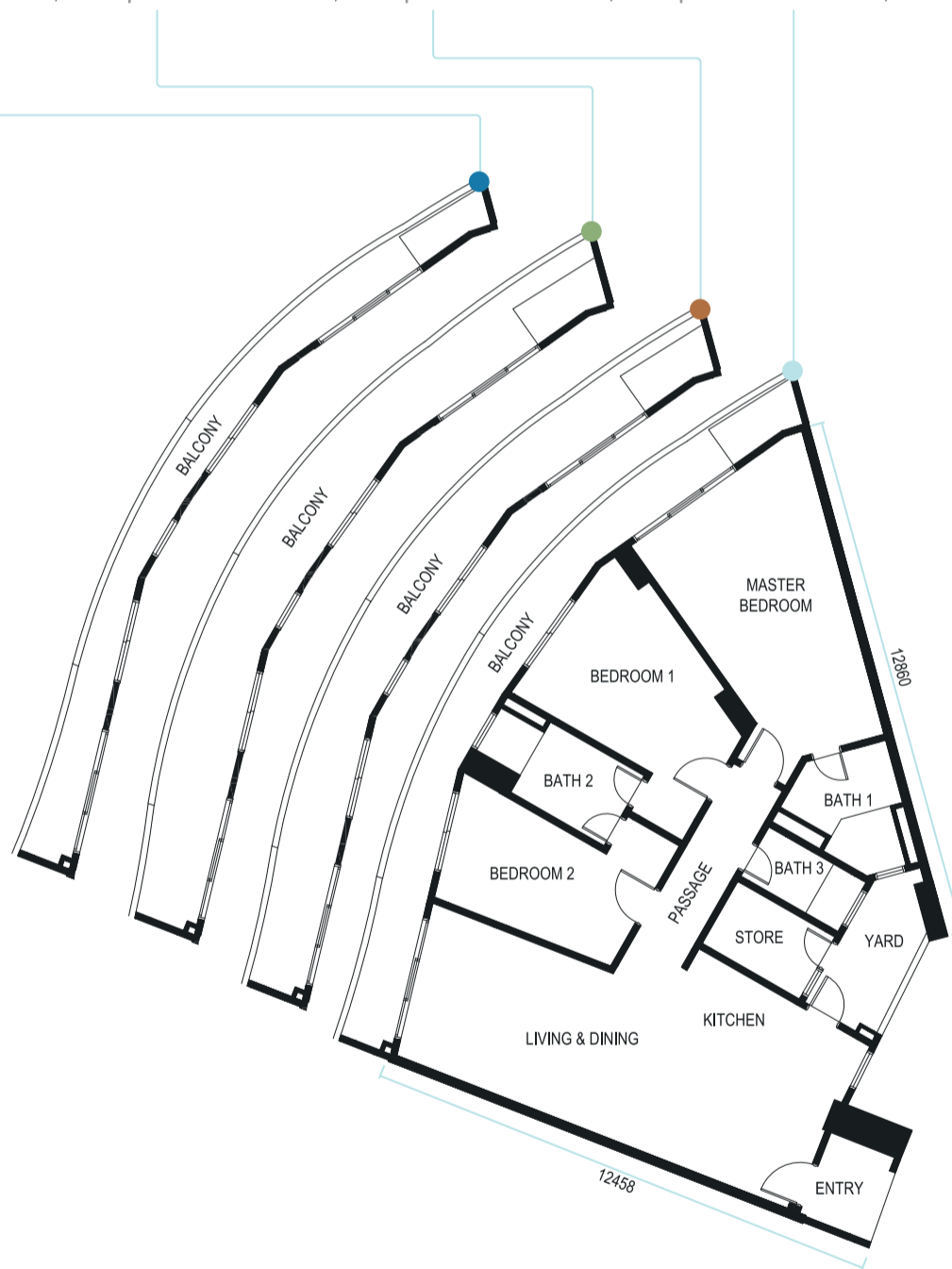

Note :  
• Subject to variations, modifications and substitutions as may be required by the Authorities or recommended by Architect or Engineer.  
• Subject to the final survey by the licensed land surveyor.





BLOCK

# D 1

## Floor Layout

